

**SANDLER**

**SANDLER SOUTHWEST CORP**

4965 Preston Park Boulevard, Suite 100  
 Plano, Texas 75093  
 972/612-2600 fax: 972/985-2315  
 E-mail: Ncukerbaumesandersw.com

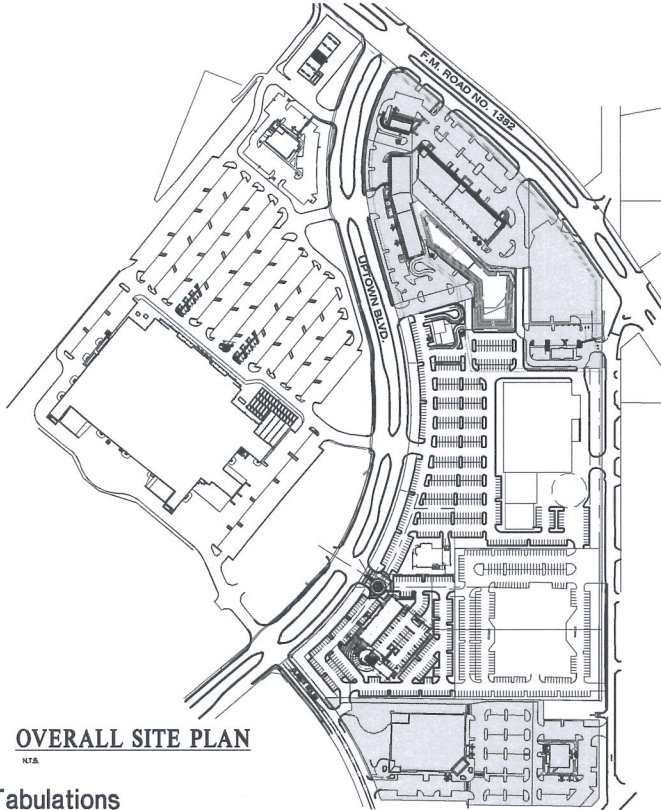

**OVERALL SITE PLAN**

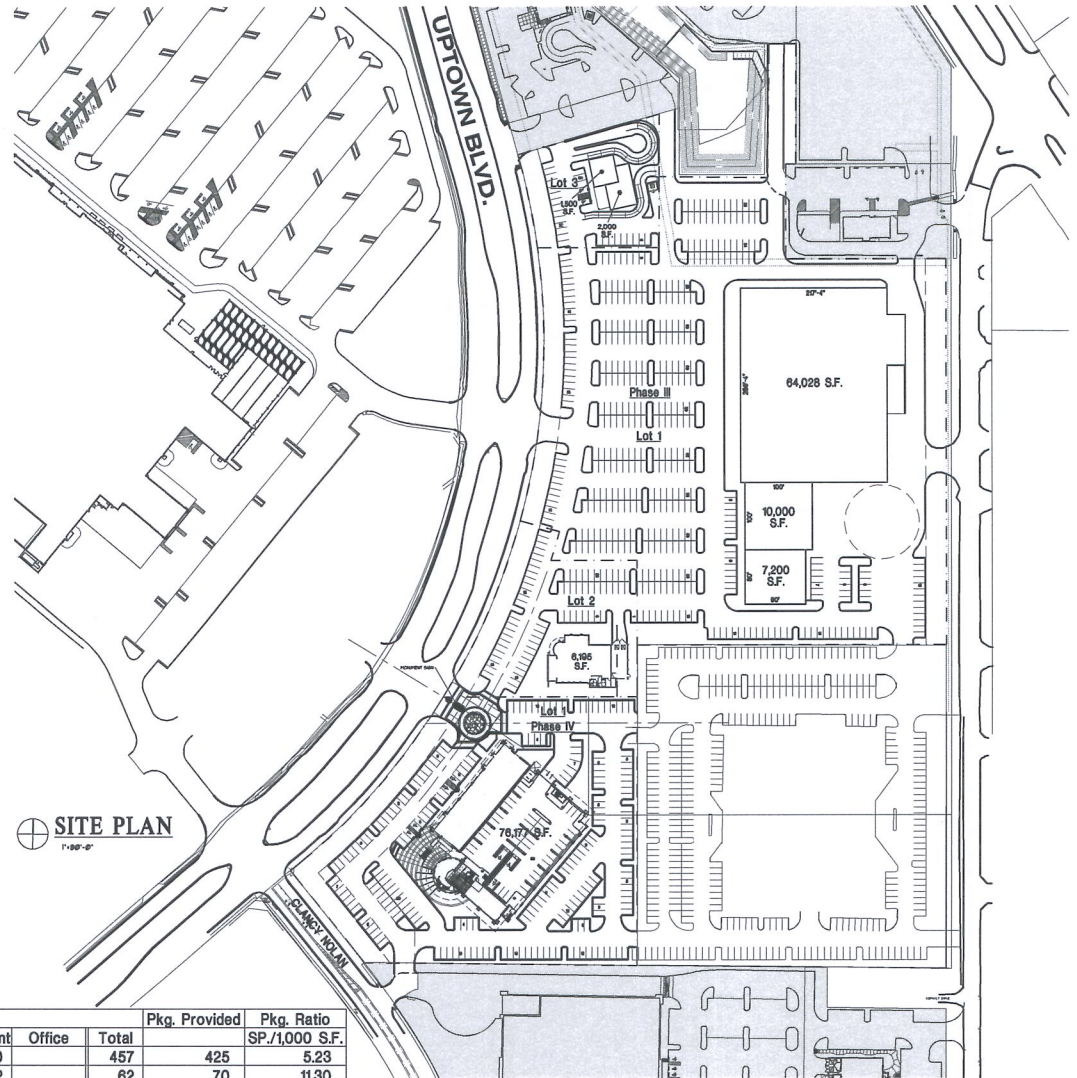

**SITE PLAN**  
 1"=80'-0"

**Tabulations**

Phase	Lot	Area		Building Area		Coverage %	Proposed Use	Parking Required				Pkg. Provided	Pkg. Ratio SP./1,000 S.F.
		S.F.	AC.	S.F.	AC.			Retail	Restaurant	Office	Total		
III	1	358,433	8.23	81,228	22.66	Retail/Restaurant	357	100		457	425	5.23	
	2	51,092	1.17	6,195	12.13	Restaurant		62		62	70	11.30	
	3	32,742	0.75	3,500	10.69	Restaurant		35		35	28	8.00	
IV	1	162,048	3.72	76,177	21.15	Office			254	254	261	3.43	
<b>Total</b>		<b>604,315</b>	<b>13.87</b>	<b>167,100</b>					<b>808</b>	<b>784</b>	<b>4.69</b>		

**Notes:**  
 • Pkg. Req.: Ret.: 1/200 Rest.: 1/100



**O'BRIEN & ASSOCIATES, INC.**  
 ARCHITECTURE ■ INTERIORS ■ PLANNING  
 5310 HARVEST HILL ROAD ■ SUITE 100 ■ DALLAS, TEXAS 75220 ■ (972) 758-1010 ■ FAX: (972) 758-4828  
 www.obriensarch.com

**CEDAR HILL TOWN CENTER - PHASE III & IV**  
 CEDAR HILL, TEXAS  
**SANDLER SOUTHWEST CORP.**

**SP-06**

SCALE: AS NOTED • JOB#: 26162 • ISSUE DATE: 07/30/07  
 APPROVED BY: \_\_\_\_\_ DATE: \_\_\_\_\_

COPYRIGHT © 2007 O'BRIEN & ASSOCIATES, INC.  
 THESE DRAWINGS OR PARTS THEREOF, MAY NOT BE REPRODUCED OR TRANSMITTED IN ANY FORM OR BY ANY METHOD,  
 FOR ANY PURPOSE, WITHOUT PRIOR WRITTEN CONSENT FROM O'BRIEN & ASSOCIATES, INC.